

単列アンギュラ玉軸受
内径30~90mm

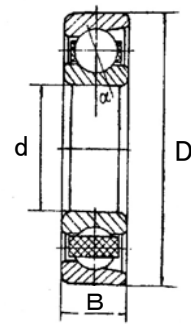

単列

主要寸法(mm)Dimensions			呼び番号 Number	接触角 α Type of Angles		
内径 d	外径 D	厚み B		15° /精度	25° /精度	40°
30	62	16	7206	C	AC/P5	-
	72	19	7306	C	AC	-
	90	23	7406	-	AC	-
35	72	17	7207	C	AC/P5	-
	80	21	7307	C/P6	AC/P6	-
	100	25	7407	-	AC	-
40	68	15	7008	-	AC	-
	80	18	7208	C	AC/P5	-
	90	23	7308	C	AC/P5	-
	110	27	7408	-	AC	-
45	75	16	7009	C	AC	-
	85	19	7209	C	AC/P5	-
	100	25	7309	C	AC/P5	-
	120	29	7409	-	AC	-
50	80	16	7010	C	AC	-
	90	20	7210	C	AC/P5	-
	110	27	7310	C	AC/P5	-
55	90	18	7011	C	AC	-
	100	21	7211	C	AC	-
	120	29	7311	C	AC	-
60	95	18	7012	C	AC	-
	110	22	7212	C	AC	-
	130	31	7312	C	AC	-
65	100	18	7013	C	AC	-
	120	23	7213	C	AC	-
	140	33	7313	C	AC	-
70	110	20	7014	C	AC	-
	125	24	7214	C	AC	-
	150	35	7314	C	AC	-
75	130	25	7215	C	AC	-
	160	37	7315	C	AC	-
80	140	26	7216	C	AC	-
	170	39	7316	C	AC	-
85	150	28	7217	C	AC	-
	180	41	7317	C	AC	-
90	140	24	7018	C	AC	-
	160	30	7218	C	AC	-

組合せアンギュラ玉軸受
内径25~100mm

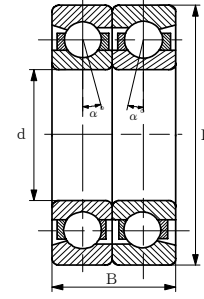
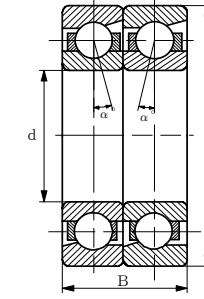
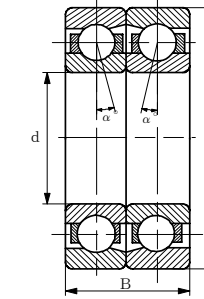

組合せ

正面

並列

背面

主要寸法(mm)Dimensions			呼び番号 Number	種類と接触角 α Type of bearings and angles								
内径 d	外径 D	厚み B		正面 (DF)			並列 (DT)			背面 (DB)		
			15°	25°	40°	15°	25°	40°	15°	25°	40°	
25	47	24	7005	C/DF	AC/DF	-	C/DT	AC/DT	-	C/DB	AC/DB	-
	52	30	7205	C/DF	AC/DF	B/DF	C/DT	AC/DT	B/DT	C/DB	AC/DB	B/DB
	62	34	7305	C/DF	AC/DF	B/DF	C/DT	AC/DT	B/DT	C/DB	AC/DB	B/DB
30	55	26	7006	C/DF	AC/DF	-	C/DT	AC/DT	-	C/DB	AC/DB	-
	62	32	7206	C/DF	AC/DF	B/DF	C/DT	AC/DT	B/DT	C/DB	AC/DB	B/DB
	72	38	7306	C/DF	AC/DF	B/DF	C/DT	AC/DT	B/DT	C/DB	AC/DB	B/DB
35	62	28	7007	C/DF	AC/DF	-	C/DT	AC/DT	-	C/DB	AC/DB	-
	72	34	7207	C/DF	AC/DF	B/DF	C/DT	AC/DT	B/DT	C/DB	AC/DB	B/DB
	80	42	7307	C/DF	AC/DF	B/DF	C/DT	AC/DT	B/DT	C/DB	AC/DB	B/DB
40	68	30	7008	C/DF	AC/DF	-	C/DT	AC/DT	-	C/DB	AC/DB	-
	80	36	7208	C/DF	AC/DF	B/DF	C/DT	AC/DT	B/DT	C/DB	AC/DB	B/DB
	90	46	7308	C/DF	AC/DF	B/DF	C/DT	AC/DT	B/DT	C/DB	AC/DB	B/DB
45	75	32	7009	C/DF	AC/DF	-	C/DT	AC/DT	-	C/DB	AC/DB	-
	85	38	7209	C/DF	AC/DF	B/DF	C/DT	AC/DT	B/DT	C/DB	AC/DB	B/DB
	100	50	7309	C/DF	AC/DF	B/DF	C/DT	AC/DT	B/DT	C/DB	AC/DB	B/DB
50	80	32	7010	C/DF	AC/DF	-	C/DT	AC/DT	-	C/DB	AC/DB	-
	90	40	7210	C/DF	AC/DF	B/DF	C/DT	AC/DT	B/DT	C/DB	AC/DB	B/DB
	110	54	7310	C/DF	AC/DF	B/DF	C/DT	AC/DT	B/DT	C/DB	AC/DB	B/DB
55	90	36	7011	C/DF	AC/DF	-	C/DT	AC/DT	-	C/DB	AC/DB	-
	100	43	7211	C/DF	AC/DF	B/DF	C/DT	AC/DT	B/DT	C/DB	AC/DB	B/DB
	120	58	7311	C/DF	AC/DF	B/DF	C/DT	AC/DT	B/DT	C/DB	AC/DB	B/DB
60	95	36	7012	C/DF	AC/DF	-	C/DT	AC/DT	-	C/DB	AC/DB	-
	110	44	7212	C/DF	AC/DF	B/DF	C/DT	AC/DT	B/DT	C/DB	AC/DB	B/DB
	130	62	7312	C/DF	AC/DF	B/DF	C/DT	AC/DT	B/DT	C/DB	AC/DB	B/DB
65	100	36	7013	C/DF	AC/DF	-	C/DT	AC/DT	-	C/DB	AC/DB	-
	120	46	7213	C/DF	AC/DF	B/DF	C/DT	AC/DT	B/DT	C/DB	AC/DB	B/DB
	140	62	7313	C/DF	AC/DF	B/DF	C/DT	AC/DT	B/DT	C/DB	AC/DB	B/DB
70	110	40	7014	C/DF	AC/DF	-	C/DT	AC/DT	-	C/DB	AC/DB	-
	125	48	7214	C/DF	AC/DF	B/DF	C/DT	AC/DT	B/DT	C/DB	AC/DB	B/DB
	150	70	7314	C/DF	AC/DF	B/DF	C/DT	AC/DT	B/DT	C/DB	AC/DB	B/DB
75	130	50	7215	C/DF	AC/DF	B/DF	C/DT	AC/DT	B/DT	C/DB	AC/DB	B/DB
	140	52	7216	C/DF	AC/DF	B/DF	C/DT	AC/DT	B/DT	C/DB	AC/DB	B/DB
80	140	60	7218	C/DF	AC/DF	B/DF	C/DT	AC/DT	B/DT	C/DB	AC/DB	B/DB
	160	60	7218	C/DF	AC/DF	B/DF	C/DT	AC/DT	B/DT	C/DB	AC/DB	B/DB
100	180	68	7220	C/DF	AC/DF	B/DF	C/DT	AC/DT	B/DT	C/DB	AC/DB	B/DB